

floor plan & capacity chart

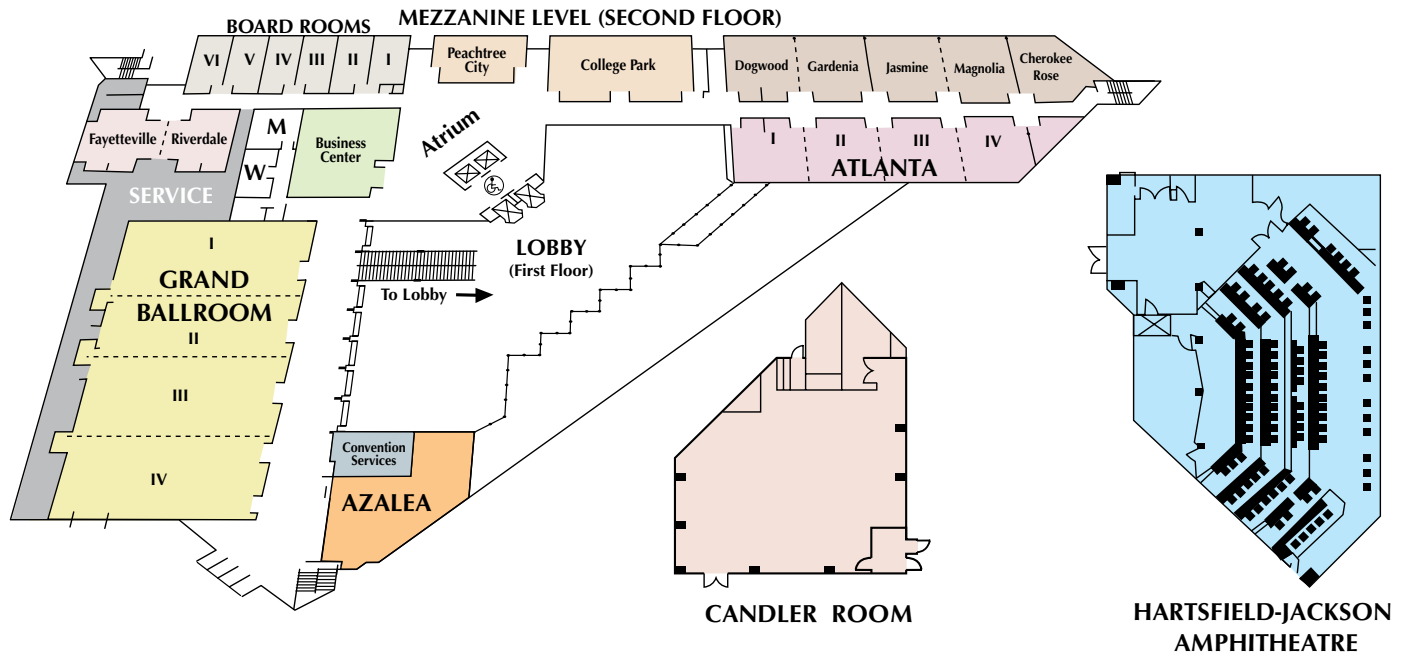

ROOM	SQ. FT.	DIMENSIONS	CEILING	THEATER	CLASSROOM	BANQUET	U-SHAPE	CONFERENCE	HOLLOW SQUARE	RECEPTION	EXHIBITS (10X10's)
GRAND BALLROOM	6,519	123' X 53'	14'	800	450	600	-	-	-	800	40
GRAND BALLROOM I	1,590	30' X 53'	14'	200	100	150	55	48	48	175	-
GRAND BALLROOM II	1,325	25' X 53'	14'	150	80	100	45	48	48	125	-
GRAND BALLROOM III	1,590	30' X 53'	14'	200	100	150	55	48	48	175	-
GRAND BALLROOM IV	2,014	38' X 53'	14'	250	130	170	60	48	48	200	-
ATLANTA	2,400	96' X 25'	9'	200	110	160	-	-	-	225	-
ATLANTA I	600	24' X 25'	9'	50	28	40	20	20	24	45	-
ATLANTA II	600	24' X 25'	9'	50	28	40	20	20	24	45	-
ATLANTA III	600	24' X 25'	9'	50	28	40	20	20	24	45	-
ATLANTA IV	600	24' X 25'	9'	50	28	40	20	20	24	45	-
CHEROKEE ROSE	600	24' X 25'	9'	50	28	40	20	20	24	45	-
MAGNOLIA	600	24' X 25'	9'	50	28	40	20	20	24	45	-
JASMINE	600	24' X 25'	9'	50	28	40	20	20	24	45	-
GARDENIA	600	24' X 25'	9'	50	28	40	20	20	24	45	-
DOGWOOD	600	24' X 25'	9'	50	28	40	20	20	24	45	-
COLLEGE PARK	1,200	48' X 25'	9'	100	50	80	30	40	40	100	-
PEACHTREE CITY	540	30' X 18'	9'	25	-	30	-	15	20	30	-
FAYETTEVILLE	504	24' X 21'	8'	50	20	40	20	20	24	40	-
RIVERDALE	504	24' X 21'	8'	50	20	40	20	20	24	40	-
BOARDROOMS (I-VI)	264	12' X 22'	8'	-	-	-	-	12	-	-	-
HARTSFIELD-JACKSON AMPHITHEATRE	2,100	-	-	-	92	-	-	-	-	-	-
HARTSFIELD-JACKSON FOYER	1,310	-	-	-	-	30	-	-	-	35	-
ATRIUM	-	-	-	-	-	90	-	-	-	125	6
CANDLER	2,568	-	-	200	100	180	46	40	46	150	18
AZALEA	1,372	-	9.5'	50	40	100	20	20	24	100	-